

Well Flow Management

Well Testing | Disposal

Pipe Work and Data Header

Pipe work is used to connect the various major equipment elements of a well test package, from the rig floor, through the well test area to the flaring/disposal system.

Expro maintains a complete stock of pipe work for all the various types of end connections currently available. Hammer union connected pipe work is the most common for well test purposes as they offer fast and efficient 'rig - up' and 'rig - down' time for systems rated up to 10,000 psi.

For High Pressure piping upstream of the choke manifold, hub and flange type connections are supplied. All pipework is fitted with the appropriate seals dependent on pressure, temperature, fluid properties and flow rates.

Data Headers are placed upstream and downstream of the choke manifold and have either three or four data points, allowing access for sampling, instrumentation or electronic data system collection. For 15,000 psi data headers, all the ports are 9/16" autoclave.

Expro operational standards also prescribes the installation of temporary pipework restraints, which are mandatory where hydrocarbons are pumped or flowed through pipework.

These safety measures are in place to protect personnel, equipment and the environment from the consequences of any catastrophic failure that may occur under system pressure.

Applications

- Onshore oil and gas well testing
- Offshore oil and gas well testing
- Clean-up operations

Features and benefits

- Pressure and temperature rated to meet hostile environments where applicable
- Designed and manufactured to comply with Industry Standards
- Colour coded to identify service and pressure rating
- Individually serialized with traceable certification
- Wide range of sizes from 2" to 6"
- Various Weco union and hub connectors available

Hammer Union

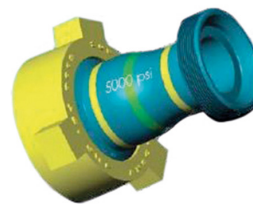

Hub Connection

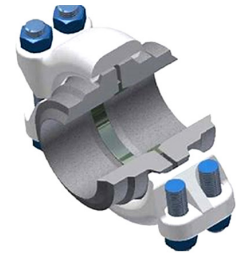

Flange Connection



Weld Neck Connection



Well Flow Management

Well Testing | Disposal

Pipe Work and Data Header

Technical specifications	
Range of working pressures psi (bar)	2,000 to 15,000 (138 to 1,034)
Range of working temperature for hammer unions °F (°C)	-20 to 250 (-29 to 121)
Range of working temperature for hub pipework and data headers °F (°C)	-40 to 350 (-40 to 177)
Range of sizes (nominal bore) inches	2, 3, 4 and 6
Type of Weco unions	Fig 206, 602, 1002, 1502, 2202
Type of hub connections	3" C25, 4" D31, 4" D27, 6" GR52 and 6" GR46
Hammer union design codes	ANSI B31.3, NACE MR0175, API 6A
Common pipe work lengths ft. (m)	3, 5, 7 and 10 (0.91, 1.52, 2.13 and 3.05)
Elbows	45° or 90°, Long or Short Radius
Cross over's sizes and pressure rating	Various

Note: 2" 602 are not available and no longer utilized.

Other sizes, configurations and pressure ratings are available to meet most applications. For more information contact your local Expro representative or email: welltesting@expro.com